

Section B-B
81ST1

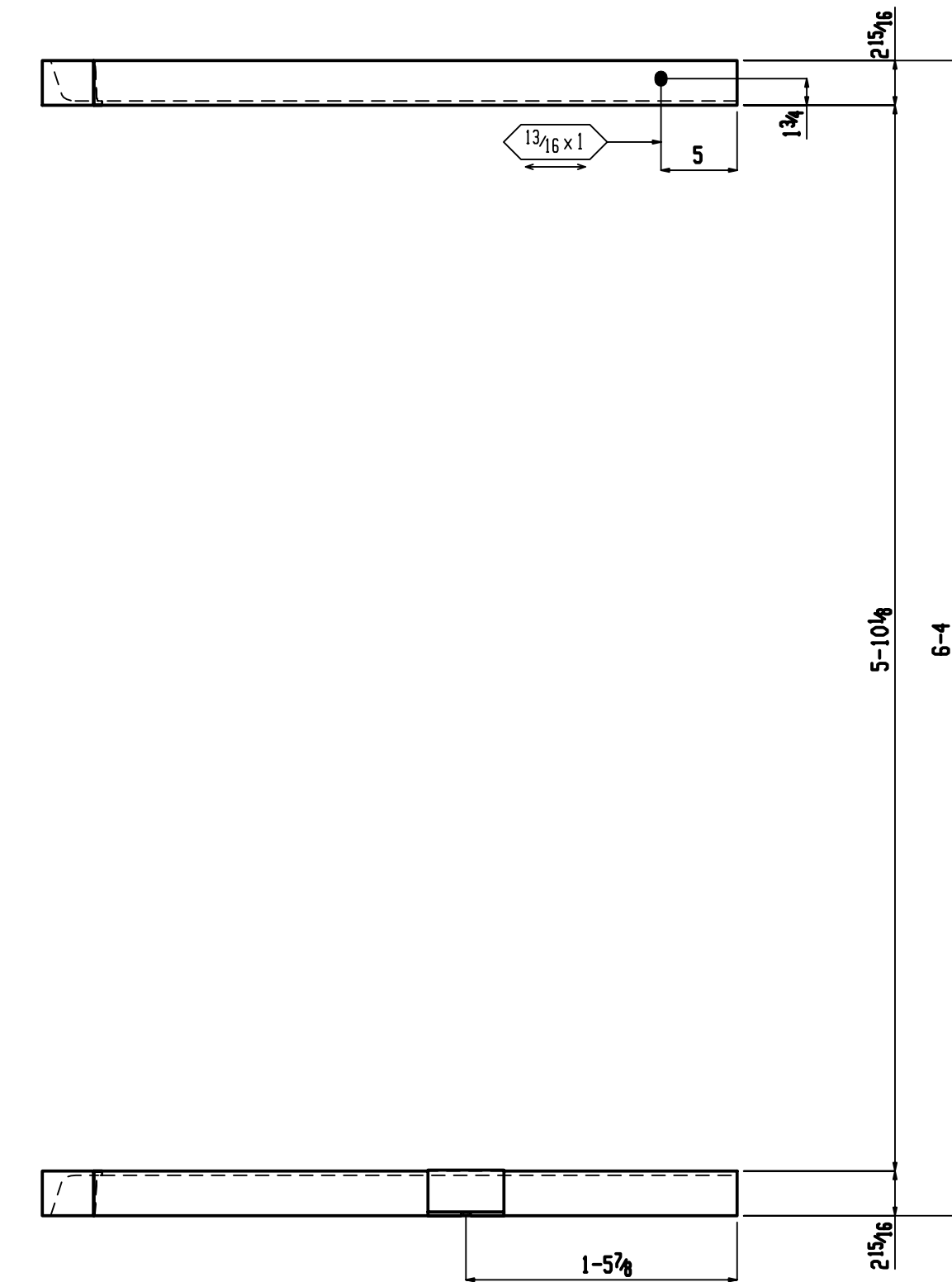

Section C-C
81ST1

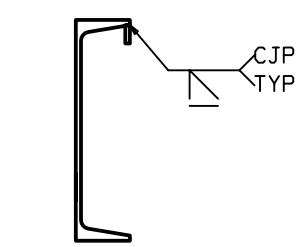

Section D-D
82ST1

READ THIS SHEET
ALONG WITH 81A

- ALL MATERIAL TO BE A36 UNLESS NOTED
- ALL TUBES TO BE A500-GRB (Fy=46) UNLESS NOTED
- ALL PIPES TO BE A53-GRB UNLESS NOTED
- ALL HS SHOP BOLTS TO BE TORQUED UNLESS NOTED
- ALL RUNNING DIMENSIONS FROM END OF MAIN MATERIAL
- ALL SHOP WELDS TO BE E70XX-LH ELECTRODES
- ALL COPES TO BE RADIUSED
- ALL BEAM TO BE FABRICATED WITH RESIDUAL CAMBER UP
- MEMBERS ARE TO BE ERRECTED SO THAT MARKED END IS IN SAME LOCATION AS ON ERECTION DRAWING